



2023 ANNUAL CONFERENCE

JUNE 25-29

Epidemiology Elevated:
Supporting People and Places



Salt Lake City
UTAH



#CSTE2023



csteconference.org

Pocket Agenda

CSTE Conference App

Download the mobile app for easy access to everything happening at the **2023 CSTE Annual Conference**.

HOW TO DOWNLOAD

- 1 iOS and Android:** Search and download "2023 CSTE Annual Conference" from your app store.
- 2 Open the App:** Select the "CSTE 2023" icon from your device screen and sign in using the same username and password used to access the online agenda.
- 3 Explore:** Allow push notifications if prompted for conference alerts.



Contents

Floor Plans 4

General Conference
Information 11

Key Speakers 21

Saturday 33
**June 24 • Check-In
and Badge Pick-Up**

Sunday 35
June 25 • Workshops

Monday 41
June 26 • Day 1

Tuesday 57
June 27 • Day 2

Wednesday 75
June 28 • Day 3

Thursday 85
June 29
CSTE Business Meeting

Sponsors 91

Exhibitors 93

Networking Hall 94

Sponsored Roundtable
Sessions 96

CSTE Membership 101

CSTE Foundation 102

2024 Annual Conference . . 105

#CSTE2023

Epidemiology Elevated:
Supporting People
and Places



Salt Palace Convention Center

LEVEL 1

Meeting rooms in this venue are indicated in **PEACH** in the pocket agenda.

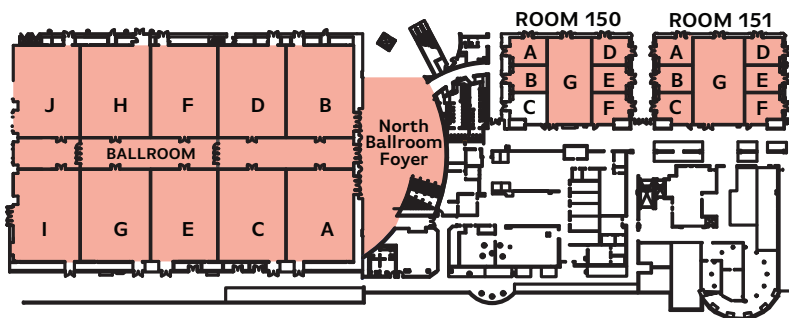

- ◆ North Ballroom Foyer / Satellite Check-In & Registration
- ◆ Ballroom A-H / Plenary Session
- ◆ 150 AB / Speaker Ready Room
- ◆ Ballroom I, Ballroom J, 150 DEFG / Breakout
- ◆ 151 ABC, 151 G, 151 DEF / Roundtable

Salt Palace Convention Center

LEVEL 2

Meeting rooms in this venue are indicated in **PEACH** in the pocket agenda.

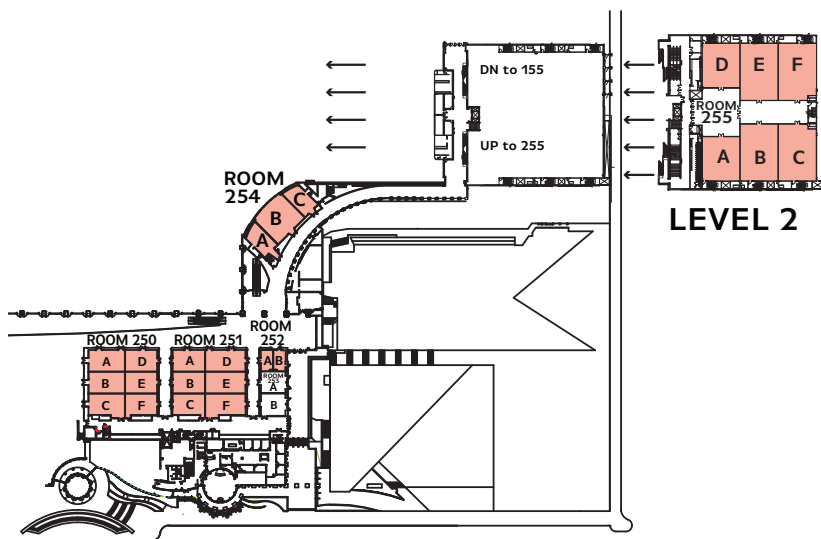

- ◆ 250 ABC, 250 DEF, 251 ABC, 251 DEF, 254 ABC, 255 A, 255 B, 255 C, 255 E, 255 F / Breakout
- ◆ 255 D / Attendee Quiet Working Room
- ◆ 252 AB / Roundtable

Hyatt Regency Salt Lake City

LEVEL 2

Meeting rooms in this venue are indicated in **TEAL** in the pocket agenda.

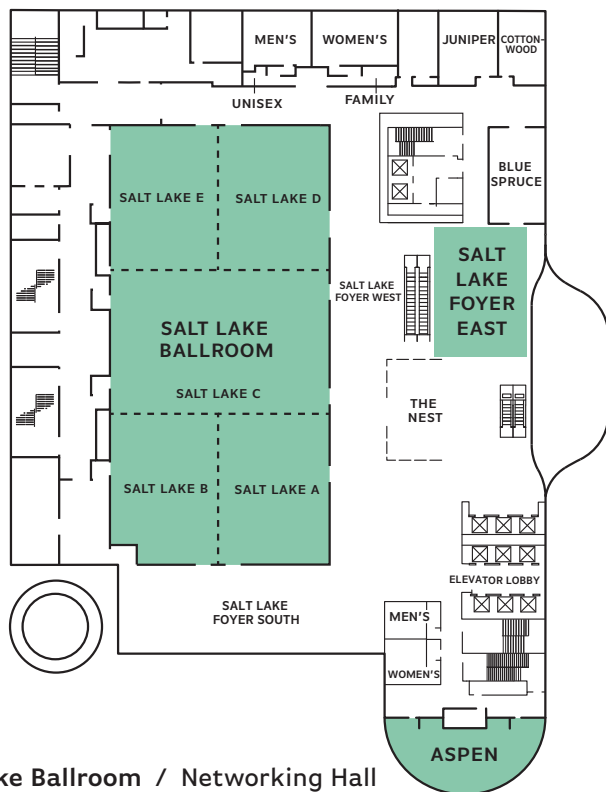

- ◆ Salt Lake Ballroom / Networking Hall
- ◆ Salt Lake Foyer East / Check-In & Registration
- ◆ Aspen / Roundtable

Hyatt Regency Salt Lake City

LEVEL 3

Meeting rooms in this venue are indicated in **TEAL** in the pocket agenda.

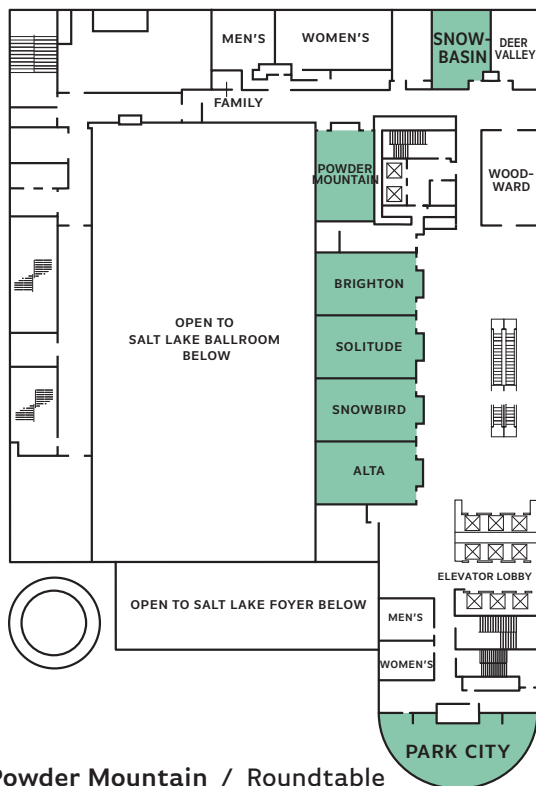

- ◆ Snowbasin, Powder Mountain / Roundtable
- ◆ Brighton, Solitude, Snowbird, Alta / Roundtable
- ◆ Park City / Roundtable

Hyatt Regency Salt Lake City

LEVEL 4

Meeting rooms in this venue are indicated in **TEAL** in the pocket agenda.

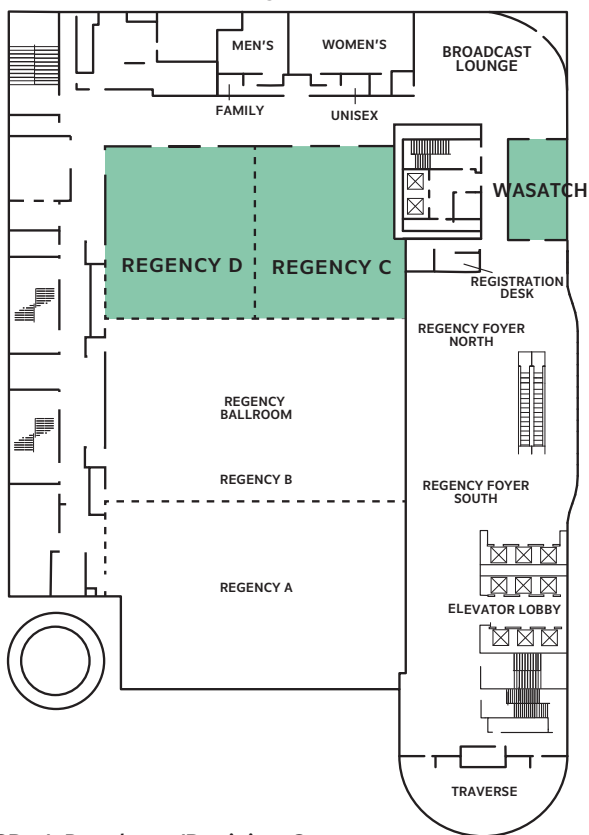

- ◆ Regency CD / Breakout/Position Statement
- ◆ Wasatch / Position Statement Office

Salt Palace Convention Center

LEVEL 1 / POSTERS

121 122 123 124 125 126 127 128 129 130 131 132 133 134 135 136 137 138 139 140 141 142 143 144 145 146 147 148

101 102 103 104 105 106 107 108 109 110 111 112 113 114 115 116 117 118 119 120

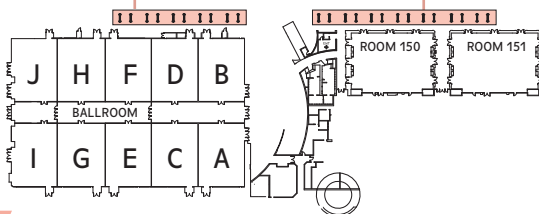

LEVEL 2 POSTERS

201 202 203 204 205 206 207 208 209 210 211 212 213 214 215 216 217 218 219 220 221 222 223 224

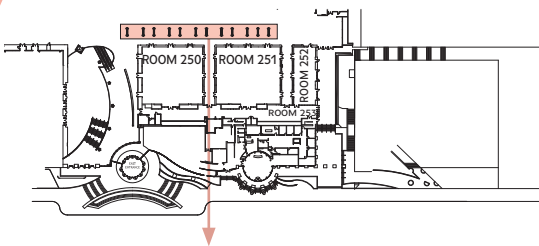

LEVEL 2 / POSTERS

10

A horizontal number line with tick marks every 1 unit. The numbers 301, 302, 303, 304, 305, 306, 307, 308, 309, 310, 311, 312, 313, 314, 315, 316, 317, 318, 319, 320, 321, 322, 323, 324, 325, 326, 327, 328, 329, and 330 are labeled below the line.

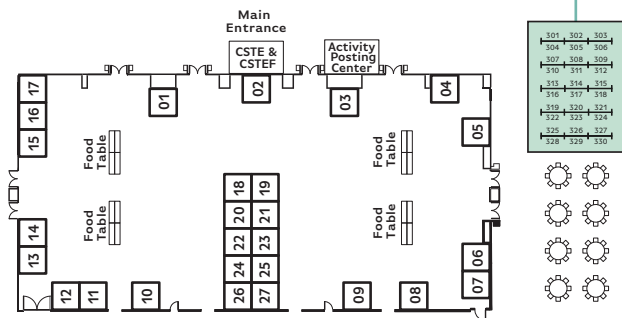

General Info



Salt Lake City
UTAH



#CSTE2023

**Epidemiology Elevated:
Supporting People and Places**





Welcome to the 2023 CSTE ANNUAL CONFERENCE

Agenda information is provided through the pocket agenda, mobile app, and online agenda. The pocket agenda is as of May 4, 2023. The conference app is available for iPhone/iPad and Android. Access the online agenda at www.cste.org/2023agenda or app at www.cste.org/2023app for agenda details and the latest information.

Conference Check-In and Onsite Registration

Attendee check-in and onsite registration is located at the Hyatt Regency Salt Lake City on Saturday through Wednesday, and satellite check-in and onsite registration is located at the Salt Palace Convention Center on Sunday through Tuesday.

DESK HOURS	Hyatt Regency Salt Lake City	Salt Palace Convention Center
Sat / 2:00pm – 5:00pm	◆	
Sun / 7:00am – 4:00pm	◆	◆
Mon / 7:30am – 4:00pm	◆	◆
Tues / 7:30am – 4:00pm	◆	◆
Wed / 8:00am – 11:00pm	◆	

Activity Posting Center

A bulletin board is located outside the Networking Hall for attendees to post flyers, job openings, messages, or special events.



Conference Evaluation

Please plan on giving us your feedback about the CSTE Annual Conference by completing a conference evaluation. Starting June 28, 2023 a link to the overall online evaluation will be available on the CSTE conference website and at www.cste.org/2023conferenceeval.

All those completing an overall conference evaluation by July 28, 2023, will be eligible for our prize drawings.

Continuing Education Credits

CSTE is offering continuing education (CE) in partnership with the Centers for Disease Control and Prevention at the 2023 CSTE Annual Conference for doctors, nurses, health educators, veterinarians, those Certified in Public Health (CPH), and general practitioners. Up to 13 hours will be available at no additional cost, pending application approval, for attending conference workshops, the Jonathan Mann Lecture and select plenary sessions. Instructions to claim CE will be posted on the conference website and emailed to attendees after the conference.

Lactation Rooms

Lactation rooms are available at the Salt Palace Convention Center off of the Lower Concourse between the North Ballroom Foyer and Room 150 A (underneath the triple escalators) and across from Room 254 between the bathrooms.

Lost and Found

Items accidentally left in meeting rooms may be turned in at the CSTE Registration Desk. Any items not retrieved by the close of registration each day will be turned over to the convention center or hotel security.



Luggage

Due to security concerns and limited meeting space, CSTE cannot hold luggage for attendees. Please check with your hotel for options to store your luggage. Luggage should not be brought to a meeting room if it obstructs pathways in the room.

Masking

Masks will be optional during all meeting and gathering functions. All attendees should be mindful and respectful of other attendees when eating, drinking, or presenting. A limited number of masks will be available at the Check-In & Registration desks, and attendees are encouraged to bring a mask, if preferred. CSTE will not monitor or enforce mask usage by individual attendees, but we ask attendees to honor the request of others to physically distance. CSTE reserves the right to ask an attendee to leave should they be deemed rude, uncooperative, or disrespectful.

Meeting Locations

Conference sessions are at the Salt Palace Convention Center and Hyatt Regency Salt Lake City. Meeting rooms are displayed in color by venue on the floor plan and throughout the pocket agenda.



Networking

Join us for networking events during the conference.

Sun / June 25	6:00pm – 7:30pm	Networking Reception featuring CSTE Fellowship, Trotti at Hilton Salt Lake City Center
Mon / June 26	6:00pm – 7:30pm	Opening Reception, Hyatt Regency Salt Lake City, Salt Lake Ballroom
Tues / June 27	6:30am – 7:30am	5k Group Walk/Run
Tues / June 27	6:00pm – 7:30pm	CSTE Social Hour, Hyatt Regency Salt Lake City, Sundance Terrace

Passport to Prizes

Join the fun and fill out your Passport to Prizes by visiting our sponsors and exhibitor booth in the Networking Hall, exchanging ideas, and sharing resources. All attendees can pick up a passport card at the Check-In & On-Site Registration desks on Sunday, June 25 and Monday, June 26. Attendees should visit and obtain a stamp from at least fifteen (15) of the participating sponsors and exhibitors in order to be eligible for the prize drawings during the Opening Reception on Monday, June 26.

Position Statement Office

Computer stations are available for position statement authors to edit and print proposed position statements. The office is available for extended hours on Wednesday for position statement authors. Printing and photocopying are only available for position statements.



Poster Schedules

Posters are displayed for a day and one-half starting on Sunday until Wednesday. Poster board number assignments are available in the online agenda and app. Posters in the 100s are located on the Lower Concourse of the Salt Palace Convention Center, and posters in the 200s are located on the Upper Concourse of the Salt Palace Convention Center. Posters in the 300s are located on the 2nd Level of the Hyatt Regency Salt Lake City. Poster presentations will be held during the following times.

PRESENTATION DATE	DISPLAY START	DISPLAY END
Sun / 3:00pm	Sun / 12pm	Mon / 4pm
Mon / 8:15am	Sun / 12pm	Mon / 4pm
Mon / 10:00am Poster Award Finalists	Sun / 12pm	Wed / 12pm
Mon / 3:15pm	Sun / 12pm	Mon / 4pm
Tues / 8:15am	Tues / 7:30am	Wed / 12pm
Tues / 10:00am	Tues / 7:30am	Wed / 12pm
Tues / 3:15pm	Tues / 7:30am	Wed / 12pm
Wed / 8:15am	Tues / 7:30am	Wed / 12pm
Wed / 10:00am	Tues / 7:30am	Wed / 12pm

Posterpalooza

View the work of your colleagues and fill out your Posterpalooza card by browsing the posters displayed throughout the Salt Palace Convention Center and Hyatt Regency Salt Lake City. All attendees can pick up a Posterpalooza card at the Check-In & On-Site Registration desks from Sunday, June 25 to Tuesday, June 27. Attendees should visit at least one (1) poster from each Committee and fill in the corresponding information in order to be eligible for the prize drawing during the CSTE Social Hour on Tuesday, June 27.



Quiet Working Room

A quiet working room will be available at the Salt Palace Convention Center in 255 D on Monday through Wednesday. We ask that attendees working in this space please be respectful and of others working in the space and keep noise to a minimum.

Session Schedules

Sessions on Monday through Wednesday follow the standard schedule below:

SESSION TYPE	MORNING	AFTERNOON
Breakout	8:45am – 10:00am	2:00pm – 3:15pm 3:45pm – 5:00pm
Plenary	10:30am – 11:45am	
Poster	8:15am – 8:45am 10:00am – 10:30am	3:00pm – 3:30pm <i>Sunday Only</i> 3:15pm – 3:45pm <i>Monday & Tuesday Only</i>
Roundtables	7:30am – 8:15am	12:45pm – 1:30pm 5:15pm – 6:00pm

Social Media

Join us on social media for alerts and updates at



www.facebook.com/CSTE.org and



<https://twitter.com/csteconference>

or see the CSTE conference website at
www.csteconference.org for more information.

Be sure to use the conference hashtag **#CSTE2023** when posting to social media during the week.



Speaker Ready Room

Computers stations are available in room 150AB at the Salt Palace Convention Center for presenting authors to upload or update their presentation no later than 24 hours prior to the start of their session. Printing is only available for presenting authors. Presenting authors may print one (1) copy of their presentation if needed.

T-Shirts

T-shirts are available for pre-purchase through conference registration only with limited sizes available after early-bird registration. T-shirts ordered through conference registration may be picked up during open hours at Check-In & On-Site Registration at the Hyatt Regency Salt Lake City during on Saturday, June 24 through Tuesday, June 27.

Wireless Internet

Complimentary wireless internet is available at the Salt Palace Convention Center and the Hyatt Regency Salt Lake City.

Salt Palace Convention Center
Network: **SP Guest**

Once connected to the network, a splash page will walk you through creating an account, which is required in order to connect to the WiFi. A complimentary account allows for one (1) hour of connectivity. If longer access is needed, you can sign up for complimentary access again or choose the daily option for 24 hours (or more) of continuous service for \$15.00 per day. Purchased WiFi will not be reimbursed by CSTE.

Questions

Additional onsite information is provided on the CSTE conference website at www.csteconference.org and mobile app. If you can't find what you are looking for or have any questions, please see a member of the National Office Staff at the registration desk.

notes



Key Speakers



Salt Lake City
UTAH



Epidemiology Elevated: Supporting People and Places

#CSTE2023

#CSTE2023

Epidemiology Elevated:
Supporting People and Places



MONDAY • JUNE 26

10:30am–11:45am

Upping Our Game: Engagement with Health Care and Communities

MODERATORS

Angela Dunn, *CSTE President*

Janet Hamilton, *CSTE Executive Director*

AWARDS

Pumphandle Award

Fellow Awards

SPEAKERS

Andrew T. Pavia, MD, FAAP, FACP, FIDSA

University of Utah

Jill Jim, PhD, MPH, MHA

Navajo Nation

SPEAKER BIOS



Andrew T. Pavia, MD, FAAP, FACP, FIDSA

University of Utah

Andrew Pavia M.D. is the George and Esther Gross Presidential Professor and Chief of the Division of Pediatric Infectious Diseases and adjunct Professor of Medicine at the University of Utah. He also serves as Director of Hospital Epidemiology at Primary Children's Medical Center and Associate Director of the Antimicrobial Stewardship Program. He received his

Andrew Pavia M.D. (continued)

MD from Brown University and was a resident and Chief resident in Medicine at Dartmouth. He served as an EIS officer and Preventive Medicine Resident at the Centers for Disease Control and Prevention (CDC) where he worked on diarrheal disease and HIV. He did Pediatric and Adult ID fellowship at the University of Utah.

He currently serves as an advisor to CDC and the Utah Department of Health on COVID-19, and is a member of the NIH COVID-19 Treatment Guidelines Panel. He is a member of the National Academy of Science, Engineering and Medicine's (formerly known as the IOM) Preparedness Forum. Dr. Pavia co-chairs the Influenza Guidelines Writing Committee for the Infectious Disease Society of America (IDSA), and chaired the IDWeek Program Committee for 2018.

He was voted "Utahn of the year" by the Salt Lake Tribune for his efforts to advocate for children during the COVID-19 pandemic and was awarded the "Roz McGee Children's Champion" award by Voices for Utah Children.



Jill Jim, PhD, MPH, MHA

Navajo Nation

Dr. Jill Jim, an enrolled member of the Navajo Nation and former member of the Biden-Harris Transition COVID-19 Advisory Board. Dr. Jim has a Ph.D in Public Health, a Master's Degree in Health Care Administration, a second

Master's in Public Health from the University of Utah. Her career has focused on prevention of chronic diseases and addressing healthcare and health disparities among Native Americans. She has served urban and tribal communities in non-profit, state, federal agencies and most recently tribal government as an Executive Director for the Navajo Department of Health.

TUESDAY • JUNE 27

10:30am–11:45am

Environmental Justice / Advocacy: One Planet for All of Us

MODERATORS

Sarah Lyon-Callo, *CSTE President Elect*

Willy Lanier, *Planning Committee*

AWARDS

Distinguished Leader Award

Rising Leader Award

SPEAKERS

Ben Abbott, PhD

Brigham Young University

Abdul El-Sayed, PhD, MD

*Wayne County Department of Health,
Human & Veterans Services*

SPEAKER BIOS

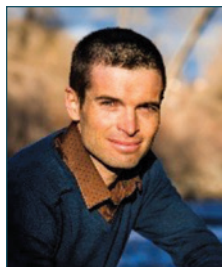

Ben Abbott, PhD

Brigham Young University

Ben Abbott was born in Nashville Tennessee and grew up in Orem Utah. He got interested in science and nature from watching TV and mountain biking in the foothills of Mount Timpanogos.

Near the end of his senior year at Orem High, he slipped on a pamphlet for the Quinney Scholarship at Utah State University and applied to the Watershed and Earth

Ben Abbott, PhD *(continued)*

Systems Science program. During his B.S., he worked as an undergraduate researcher in northern Alaska, investigating how fish influence nutrient cycles in Arctic lakes. That led to his Ph.D. at the University of Alaska Fairbanks, where he studied permafrost climate feedbacks using interdisciplinary techniques to quantify how Arctic and Boreal ecosystems respond to climate change. After finishing his Ph.D. in 2014, he worked as a Marie Curie postdoctoral fellow at the French National Science Foundation (CNRS). While in western France, he studied the effects of agriculture and urbanization on aquatic and marine ecosystems.

Ben is currently an assistant professor in the Environmental Science & Sustainability program at BYU. He works with a large team of creative and passionate students and postdoctoral researchers to understand and encourage sustainability and reciprocity among all members of the human family and all creation. Specifically, they use methods from ecosystem ecology, evolutionary biology, energy system modeling, and social science to understand and decrease environmental pollution, measure and mitigate the effects of climate change, and protect vulnerable human and nonhuman communities worldwide. He has been married to Rachel Gianni Abbott for twelve years, and they have four children who take after them in their love of animals, TV, and biking. For more information, visit his blog, *Approximately Limitless*.

**Abdul El-Sayed, PhD, MD**

*Wayne County Department of Health,
Human & Veterans Services*

Dr. Abdul El-Sayed is a physician, epidemiologist, and public servant. He serves as director of Wayne County's Department of Health, Human & Veterans Services and health officer

for the county, serving 1.8 million residents of Michigan's largest and most diverse county under Chief Executive Warren Evans. Abdul hosts Crooked Media's award-winning "America Dissected" podcast, attracting tens of thousands of weekly listeners to go beyond the headlines to explore the intersection between health and society. His three books include "Healing Politics," calling for a politics of empathy to cure our epidemic of insecurity, and "Medicare for All: A Citizen's Guide" with Dr. Micah Johnson. His over 100 peer-reviewed publications have earned over 3,000 citations. He holds academic appointments at the intersection between public health, public policy, and politics at the University of Michigan Gerald R. Ford School of Public Policy, the FXB Center for Health & Human Rights at the Harvard T.H. Chan School of Public Health, Wayne State University, and American University. He is formerly the health director for the city of Detroit, candidate for governor of Michigan in 2018, and commentator at CNN. He's a proud member of the National Writers Union, AFT Locals 477 and 6244, SEIU Local 500, and the AAUP.

TUESDAY • JUNE 27

12:00pm–12:30pm

Jonathan Mann Memorial Lecture

MODERATORS

Angela Dunn, *CSTE President*

SPEAKER

Dr. Alfred (Al) DeMaria, Jr., MD



Dr. Alfred (Al) DeMaria, Jr., MD

Dr. DeMaria is a Medical and Laboratory Consultant at the Massachusetts Department of Public Health where he previously served as Medical Director of the Bureau of Infectious Disease and Laboratory Sciences, and for many years as State Epidemiologist for

Massachusetts. He is a graduate of Boston University and Harvard Medical School. He trained in internal medicine at Montefiore Medical Center in The Bronx, New York and in infectious diseases at Boston City Hospital and the Boston University School of Medicine. Dr. DeMaria is a Fellow of the Infectious Diseases Society of America and of the Society for Healthcare Epidemiology of America. He currently is a member or advisor on multiple committees of the Massachusetts Medical Society, as well as serving on the boards of the Grimes King Foundation and the Boston Medical Library, and as President of the Board of Directors of The Public Health Museum. He is a past president of the Council of State and Territorial Epidemiologists, the Massachusetts Infectious Diseases Society and the Northeast Branch of the American Society for Microbiology.

WEDNESDAY • JUNE 28

10:30am–11:45am

Public Health Communications: Putting the Community in our Communications

MODERATORS

Ruth Lynfield, *CSTE Vice President*

Amelia Salmanson, *Planning Committee*

AWARDS

Distinguished Partner

RWJF Award

SPEAKER

Katelyn Jetelina, MPH, PhD

Population Health Analytics

Lena H. Sun, MA

National Reporter Focusing on Health, Washington Post

SPEAKER BIOS



Katelyn Jetelina, MPH, PhD,

Population Health Analytics

Katelyn Jetelina, MPH PhD is an epidemiologist, data scientist, and internationally renowned scientific communicator. She is the Director of Population Health Analytics a nonprofit, non-partisan health policy think tank.

Katelyn Jetelina, MPH PhD *(continued)*

She is also a Senior Scientific Advisor to a number of government and non-profit agencies, including the White House, Centers for Disease Control and Prevention, Resolve to Save Lives, and Make-A-Wish Foundation. On the side, Dr. Jetelina is the publisher of Your Local Epidemiologist- a public health newsletter that "translates" ever-evolving science to the general public, which has reached over 300 million views. Dr. Jetelina has received several national awards for her work, including National Academies of Science and a medal of honor from the United States Department of Health and Human Services, Emergency Management and Medical Operations, Field Operations, and Response. Katelyn resides in San Diego, California with her husband and two toddlers.

**Lena H. Sun, MA**

*National Reporter Focusing on Health,
Washington Post*

Lena H. Sun, MA is a national reporter for The Washington Post covering health, with a special focus on public health and infectious disease. A longtime reporter at The Post, she has covered

a variety of beats, including the Metro transit system, immigration and education. She has also served as The Post's Beijing bureau chief.

Honors and Awards: Pulitzer Prize for National Reporting for coverage of the war on terrorism, part of national reporting team, 2002; Robert F. Kennedy journalism award, international print, 1994

Professional Affiliations: Association of Health Care Journalists

Education: Cornell University, BS in communication; Columbia University, MA in journalism

Languages spoken in addition to English: Mandarin, some French, some Spanish



Saturday

JUNE 24 • 2023

DAILY GLANCE

◆ Hyatt Regency Salt Lake City

START	END	ROOM	FUNCTION
2:00pm	5:00pm	Salt Lake Ballroom Foyer	Check-in and Name Badge Pick-up Only

notes



Sunday

Workshops

**JUNE
25**



Salt Lake City
UTAH



Epidemiology Elevated: Supporting People and Places

#CSTE2023

#CSTE2023

**Epidemiology Elevated:
Supporting People and Places**





DAILY GLANCE

◆ Hyatt Regency Salt Lake City		◆ Salt Palace Convention Center	
START	END	ROOM	FUNCTION
7:00am	4:00pm	Salt Lake Ballroom Foyer	Check-in and On-Site Registration
7:00am	4:00pm	North Ballroom Foyer	Satellite Check-In and On-Site Registration
8:00am	4:00pm	150AB	Speaker Ready Room
7:00am	9:00am	Salt Lake Ballroom Foyer	Coffee/Tea Service
8:30am	11:30am	Salt Lake Ballroom	Sponsor and Exhibitor Set-Up
10:00am	10:30am	Salt Lake Ballroom Foyer	AM Break ☕
12:00pm	4:00pm	Salt Lake Ballroom	Networking Hall
3:00pm	3:30pm	Salt Lake Ballroom	PM Break ☕

Lactation rooms are available at the Salt Palace Convention Center off of the Lower Concourse between the North Ballroom Foyer and Room 150 A (underneath the triple escalators) and across from Room 254 between the bathrooms.

POSTER SESSIONS

3:00pm–3:30pm

Poster presentations during this session are displayed from Sunday at noon until Monday at 4PM.



◆ Hyatt Regency Salt Lake City

DAYTIME EVENTS

11:30am–12:30pm ◆ Park City

State Epi Lunch *(Invite Only)*

The State Epi Lunch is hosted in conjunction with the CSTE Foundation.

EVENING EVENTS

5:30pm–7:00pm ◆ Trofi at Hilton Salt Lake City Center

Networking Reception featuring CSTE Fellowships

Open to all attendees.



WORKSHOPS

◆ Hyatt Regency Salt Lake City		◆ Salt Palace Convention Center	
START	END	ROOM	FUNCTION
8:00am	4:30pm	255 B	MCH Symposium // Hoist the Sail: Navigating the Depths of MCH
8:00am	12:00pm	251 DEF	Vector-borne Diseases // Tools of the Trade
8:00am	12:00pm	251 ABC	Using the Revised Applied Epidemiology Competencies (AECs) for Career Ladders, Position Descriptions and Training Plans
8:30am	5:00pm	150 DEF	Injury Surveillance // Guidance from the Field: Current Issues in Injury Surveillance Data
8:30am	4:30pm	Grand Ballroom J	Infectious Disease Forecasting
8:30am	4:30pm	250 DEF	Influenza // National Meeting of Influenza Surveillance Coordinators
9:00am	5:00pm	Regency Ballroom C/D	Surveillance/Informatics Ascending to New Heights in Surveillance and Informatics
9:00am	4:30pm	255 A	Advanced Molecular Detection // Exploring Genomic Epidemiology
9:00am	4:30pm	255 F	Enteric Disease // Strengthening and Modernizing Enteric Disease Surveillance and Outbreak Response

WORKSHOPS

◆ Hyatt Regency Salt Lake City		◆ Salt Palace Convention Center	
START	END	ROOM	FUNCTION
9:00am	4:30pm	250 ABC	Healthcare Associated Infections and Antimicrobial Resistance (HAI/AR)
9:00am	2:00pm	255 C	Occupational Health Surveillance // Surveillance Skills, Stretches, and Strategies
9:30am	5:00pm	255 D	Legionnaires' Disease // Water Utah-Iking about? Don't be salty over Legionella; we have prevention plans
10:00am	4:30pm	255 E	Environmental Health // Elevating Surveillance for Environmental Health Topics
10:00am	4:00pm	150 G	Viral Hepatitis Surveillance // Enhancing Prevention, Surveillance, and Elimination Efforts
1:00pm	5:00pm	251 ABC	Legal // Advancing Health Equity through Laws & Data
1:00pm	5:00pm	Grand Ballroom I	State Epi Forum (<i>Invite Only</i>)
1:00pm	5:00pm	254 ABC	Substance Use & Mental Health // Topics in Substance Use and Mental Health

Monday

DAY 1

JUNE
26



Salt Lake City
UTAH



Epidemiology Elevated: Supporting People and Places

#CSTE2023

#CSTE2023

**Epidemiology Elevated:
Supporting People and Places**





DAILY GLANCE

◆ Hyatt Regency Salt Lake City		◆ Salt Palace Convention Center	
START	END	ROOM	FUNCTION
7:30am	4:00pm	Salt Lake Ballroom Foyer	Check-In and On-Site Registration
7:30am	4:00pm	North Ballroom Foyer	Satellite Check-In and On-Site Registration
7:30am	4:00pm	Salt Lake Ballroom	Networking Hall
7:30am	4:00pm	255 D	Quiet Working Room
8:00am	4:00pm	150 AB	Speaker Ready Room
8:00am	4:00pm	Wasatch	Position Statement Office
8:15am	8:45am	Salt Lake Ballroom	Break ☕
10:00am	10:30am	Salt Lake Ballroom	Break ☕
11:45am	12:45pm	Salt Lake Ballroom	Break and Lunch on Own
1:30pm	2:00pm	Salt Lake Ballroom	Break and Lunch on Own
3:15pm	3:45pm	Salt Lake Ballroom	Break ☕

Lactation rooms are available at the Salt Palace Convention Center off of the Lower Concourse between the North Ballroom Foyer and Room 150 A (underneath the triple escalators) and across from Room 254 between the bathrooms.

◆ Hyatt Regency Salt Lake City

POSTER SESSIONS

8:15am–8:45am

10:00am–10:30am ◆ Poster Award Finalists

3:15pm–3:45pm

Poster presentations during these sessions are displayed from Sunday at 12PM until Monday at 4PM. Poster award finalists are displayed from Sunday at 12PM until Wednesday at 12PM.

EVENING EVENTS

6:00pm–7:30pm ◆ Salt Lake Ballroom

Opening Reception in the Networking Hall

The Opening Reception is open to all attendees and is an excellent opportunity to connect with colleagues. Join us in the Salt Lake Ballroom at the Hyatt Regency Salt Lake City. Passport to Prizes winners will be drawn during the event and must be present in order to win and claim prizes.



ROUNDTABLE SESSIONS

7:30am–8:15am

◆ Hyatt Regency Salt Lake City

◆ Salt Palace Convention Center

ROOM	COMMITTEE	SESSION
151 DEF	Chronic Disease/ Maternal and Child Health	Experiences with Developing Surveys and Surveillance Systems for Long COVID
Snowbird	Environmental Health/ Occupational Health	Harmful Algal Blooms: A Discussion about Public Health Needs and Priorities
151 G	Infectious Disease I	Improving National Fungal Disease Surveillance
151 ABC	Infectious Disease II	Leveraging Patient Transfer Network Data to Inform Multi-Drug Resistant Organism (MDRO) Prevention Efforts
Regency Ballroom C/D	Position Statements (Members Only)	Infectious Disease
Aspen	Special Topics	New Member & First Time Attendee Roundtable
Brighton	Sponsor	Public Health How Referential Data Catalyzes Patient Matching and Public Health Research, <i>Presented by LexisNexis Risk Solutions</i>
Park City	Surveillance/ Informatics I	Data Modernization, Data Interoperability and Data Sharing Initiatives for Medical Examiners and Coroners to Establish Standards-Based Data Exchange with Public Health



ROUNDTABLE SESSIONS

7:30am–8:15am

◆ Hyatt Regency Salt Lake City

◆ Salt Palace Convention Center

ROOM	COMMITTEE	SESSION
Solitude	Surveillance/ Informatics II	DMI Roundtable: Review and Input into Development of STLT DMI Priorities Documentation
Powder Mountain	Workforce Development	Addressing the Mental Health Needs of our Public Health Workforce and Interventions to Reduce Burnout and Build Resilience for Public Health Responders: Sharing Recent Findings and Gathering Audience Experiences

POSTER SESSIONS

8:15am–8:45am

Poster presentations during this session are displayed from Sunday at 12PM until Monday at 4PM.



BREAKOUT SESSIONS

8:45am–10:00am

◆ Hyatt Regency Salt Lake City

◆ Salt Palace Convention Center

ROOM	COMMITTEE	SESSION
255 B	Chronic Disease/ Maternal and Child Health	Prioritizing Healthy Youth and Adults
255 E	Environmental Health/ Occupational Health I	Drinking and Recreational Water
255 F	Environmental Health/ Occupational Health II	Climbing the Peaks and Valleys of Social Determinants of Health
150 DEFG	Infectious Disease I	Navigating High Waters
251 ABC	Infectious Disease II	Are We Related? Mpox/COVID-19/ STD/HIV Coinfection
251 DEF	Infectious Disease III	Moving Mountains: It's Worth the Shot
254 ABC	Infectious Disease IV	Canyon believe this data? Skiing the AMD pipeline
255 C	Special Topics	Data for Equity
Grand Ballroom I	Substance Use & Mental Health/Injury I	Not Just Another Delta-8 Hub: Epidemiology of Cannabis and Other Stimulant Use
Grand Ballroom J	Substance Use & Mental Health/Injury II	Off to Great Places: Innovative Methods in Injury Epidemiology



BREAKOUT SESSIONS

8:45am–10:00am

◆ Hyatt Regency Salt Lake City

◆ Salt Palace Convention Center

ROOM	COMMITTEE	SESSION
250 ABC	Surveillance/ Informatics I	Hot Spots and Cold Spots: Finding Hidden Patterns in Health Data through Cluster Detection and Modeling
250 DEF	Surveillance/ Informatics II	Flexible Surveillance Tools for Outbreak Detection and Response
255 A	Surveillance/ Informatics III	Building the Hive: Faster Collection of Case Data via Electronic Case Reporting

POSTER SESSIONS

10:00am–10:30am ◆ Poster Award Finalists

Poster presentations during this sessions are displayed from Sunday at 12PM until Wednesday at 12PM.

PLENARY SESSIONS

**Upping Our Game:
Engagement with Health Care and Communities**

10:30am–11:45am ◆ Grand Ballroom A-H

Andrew T. Pavia, MD, FAAP, FACP, FIDSA
University of Utah

Jill Jim, PhD, MPH, MHA
Navajo Nation



ROUNDTABLE SESSIONS 12:45pm–1:30pm

◆ Hyatt Regency Salt Lake City

◆ Salt Palace Convention Center

ROOM	COMMITTEE	SESSION
252 AB	Environmental Health/ Occupational Health	CSTE Environmental Health/ Occupational Health Steering Committee Update - New Members Welcome
151 ABC	Infectious Disease	Why Crowdsourcing Foodborne Illness Complaints Is Different Than Foodborne Illness Complaint Surveillance and Why It Matters
Regency Ballroom C/D	Position Statements (Members Only)	Infectious Disease
Snowbird	Special Topics I	Addressing the Data Needs of American Indian and Alaskan Native Communities By Cultivating Sustainable Partnerships between State and/ or Local Governmental Agencies and Tribes or Tribal Health Agencies
Snowbasin	Special Topics II	CSTE Law Enforcement Involved Injuries and Fatal Encounters (LEIFE) Interest Session
Brighton	Sponsor I	Public Health Department Easily Configures Custom Childhood Lead Surveillance Software to Meet Unique Needs, <i>Presented by Conduent Government Healthcare Solutions</i>



ROUNDTABLE SESSIONS 12:45pm–1:30pm

◆ Hyatt Regency Salt Lake City

◆ Salt Palace Convention Center

ROOM	COMMITTEE	SESSION
Alta	Sponsor II	Pulling It All Together: Integrating Public Health Informatics Solutions to Improve Efficiencies and Implement Lessons Learned, <i>Presented by InductiveHealth Informatics</i>
Solitude	Substance Use & Mental Health/Injury	Barriers and Opportunities for State and Local Data Linkage Strategies to Respond to the Opioid Overdose Epidemic
151 DEF	Surveillance/ Informatics I	Public Health Data Modernization: Findings from State and Federal Surveys
151 G	Surveillance/ Informatics II	Electronic Laboratory Data Use for Public Health Responses: Challenges, Opportunities, and Lessons Learned; Utility of Receiving Commercial Laboratory Mpx Testing Data at CDC
Park City	Workforce Development	Launching the Revised Applied Epidemiology Competencies (AECs)



BREAKOUT SESSIONS

2:00pm–3:15pm

◆ Hyatt Regency Salt Lake City

◆ Salt Palace Convention Center

ROOM	COMMITTEE	SESSION
255 B	Chronic Disease/ Maternal and Child Health I	Mapping People, Place, and Time to Identify Disparities
255 A	Chronic Disease/ Maternal and Child Health II	Maternal and Child Health and Infectious Disease Outcomes
255 C	Environmental Health/ Occupational Health I	Disaster Epidemiology
255 E	Environmental Health/ Occupational Health II	Air and Food
255 F	Environmental Health/ Occupational Health III	NIOSH State Partners Meeting
150 DEFG	Infectious Disease I	Graduating From The Bunny Slopes: Enhancing Hepatitis Surveillance
251 DEF	Infectious Disease II	Tick Tick Boom: Tick-borne Infections March on Like the Salt Lake Clock
251 ABC	Infectious Disease III	Climbing the Grim Reaper
254 ABC	Special Topics	Presidential Priorities



BREAKOUT SESSIONS

2:00pm–3:15pm

◆ Hyatt Regency Salt Lake City

◆ Salt Palace Convention Center

ROOM	COMMITTEE	SESSION
Grand Ballroom I	Substance Use & Mental Health/Injury I	Everything, Everywhere in Injury and Violence Epidemiology
Grand Ballroom J	Substance Use & Mental Health/Injury II	Drug Overdose Surveillance, All at Once
250 ABC	Surveillance/ Informatics I	Harnessing the Power of Automation for Public Health
250 DEF	Surveillance/ Informatics II	The Bee's Knees of Disease Detection: Swarming the Data with Syndromic Surveillance

POSTER SESSIONS

3:15pm–3:45pm

Poster presentations during this session are displayed from Sunday at 12PM until Monday at 4PM.



BREAKOUT SESSIONS

3:45pm–5:00pm

◆ Hyatt Regency Salt Lake City

◆ Salt Palace Convention Center

ROOM	COMMITTEE	SESSION
255 A	Chronic Disease/ Maternal and Child Health	Lifting Mom's Spirit, Health, and Well-Being
255 B	Environmental Health/ Occupational Health I	No Gambling Here: More Knowledge to Prevent Worker Fatalities
255 C	Environmental Health/ Occupational Health II	Raising Occupational Risk Factors to New Heights
255 F	Environmental Health/ Occupational Health III	Heat Related Illness
150 DEFG	Infectious Disease I	Complicated investigations of outbreaks due to distributed food items
251 ABC	Infectious Disease II	HAI/AR Smörgåsbord
251 DEF	Infectious Disease III	Respiratory Disease on the Slopes
Regency Ballroom C/D	Position Statement Voting Session (Members Only)	Infectious Disease I of III (NEW!)
255 E	Special Topics	Dueling Responses: From COVID to Mpox



BREAKOUT SESSIONS

3:45pm–5:00pm

◆ Hyatt Regency Salt Lake City

◆ Salt Palace Convention Center

ROOM	COMMITTEE	SESSION
Grand Ballroom I	Substance Use & Mental Health/ Injury I	Rocky Days Behind Us: Topics in Suicide & Self-Harm
Grand Ballroom J	Substance Use & Mental Health/ Injury II	Leveraging Prescription Drug Monitoring Programs to Advance Prevention of Drug Overdose and Adverse Health Outcomes
250 ABC	Surveillance/ Informatics I	Seeing is Believing: Effective and Engaging Public Health Data Visualizations
250 DEF	Surveillance/ Informatics II	Using Informatics to Support Equitable Action and Surveillance
254 ABC	Workforce Development	Driving Data Forward: Data-Centered Approaches to Workforce Development



ROUNDTABLE SESSIONS

5:15pm–6:00pm

◆ Hyatt Regency Salt Lake City

◆ Salt Palace Convention Center

ROOM	COMMITTEE	SESSION
151 DEF	Chronic Disease/ Maternal and Child Health	CSTE Neonatal Abstinence Syndrome (NAS) Standardized Surveillance Case Definition – Revisions, Future Projects
Snowbird	Environmental Health/ Occupational Health	Wastewater Monitoring Beyond Sars-Cov-2: Exploring Additional Molecular Targets
151 ABC	Infectious Disease I	Managing Influenza Surveillance Activities in a Post-COVID World
151 G	Infectious Disease II	Congenital Syphilis: How Do We Reverse the Trends?
Solitude	Special Topics	America's Poison Centers: Turning Surveillance Into Action Through Education & Feedback
Brighton	Sponsor	The Chronic Disease GIS Network (CDGISN): Enhancing GIS Capacity for Chronic Disease Prevention, <i>Presented by The Chronic Disease GIS Network (CDGISN)</i>
252 AB	Substance Use & Mental Health/Injury	Developing Strong Data Infrastructure to Support State Suicide Prevention
Park City	Surveillance/ Informatics I	Using Near Real-Time Emergency Department Visit Data for Action
Powder Mountain	Surveillance/ Informatics II	CSTE National ELR Workgroup Meet and Greet



ROUNDTABLE SESSIONS

5:15pm–6:00pm

◆ Hyatt Regency Salt Lake City

◆ Salt Palace Convention Center

ROOM	COMMITTEE	SESSION
Snowbasin	Workforce Development	Beyond the Billions: Planning for the New Epidemiology and Laboratory Capacity for Prevention and Control of Emerging Infectious Diseases (ELC) Five Year Cooperative Agreement

Tuesday

DAY 2

JUNE
27



Salt Lake City
UTAH



Epidemiology Elevated: Supporting People and Places

#CSTE2023

#CSTE2023

**Epidemiology Elevated:
Supporting People and Places**





DAILY GLANCE

◆ Hyatt Regency Salt Lake City		◆ Salt Palace Convention Center	
START	END	ROOM	FUNCTION
7:30am	4:00pm	Salt Lake Ballroom Foyer	Check-In and On-Site Registration
7:30am	4:00pm	North Ballroom Foyer	Satellite Check-In and On-Site Registration
7:30am	4:00pm	Salt Lake Ballroom	Networking Hall
7:30am	4:00pm	255 D	Quiet Working Room
8:00am	4:00pm	150 AB	Speaker Ready Room
8:00am	4:00pm	Wasatch	Position Statement Office
8:15am	8:45am	Salt Lake Ballroom	Break ☕
10:00am	10:30am	Salt Lake Ballroom	Break ☕
11:45am	12:45pm	Salt Lake Ballroom	Break and Lunch on Own
1:30pm	2:00pm	Salt Lake Ballroom	Break and Lunch on Own
3:15pm	3:45pm	Salt Lake Ballroom	Break ☕

Lactation rooms are available at the Salt Palace Convention Center off of the Lower Concourse between the North Ballroom Foyer and Room 150 A (underneath the triple escalators) and across from Room 254 between the bathrooms.



◆ Hyatt Regency Salt Lake City

POSTER SESSIONS

8:15am–8:45am

10:00am–10:30am

3:15pm–3:45pm

Poster presentations during these sessions are displayed from Tuesday at 7:30AM until Wednesday at 12PM.

MORNING EVENT

6:30am–7:30am

CSTE Run/Walk Event

Full event details, including a map of the route, is provided on the conference website and mobile app. This is open to runners and walkers of all abilities. There is no fee or registration for this event. The goal is for attendees to enjoy themselves while getting a little bit of exercise!

EVENING EVENT

6:00pm–7:30pm ◆ Sundance Terrace

CSTE Social Hour

Join us for our second CSTE Social Hour, where you can network and connect with your colleagues. Posterpalooza winners will be drawn during the event and must be present in order to win and claim prizes. Cash bar and light hors d'oeuvres will be available.



ROUNDTABLE SESSIONS

7:30am–8:15am

◆ Hyatt Regency Salt Lake City

◆ Salt Palace Convention Center

ROOM	COMMITTEE	SESSION
Park City	Environmental Health/ Occupational Health	Occupation and Industry Data Completeness and Quality in Non-COVID Reportable Conditions Case Investigations
151 ABC	Infectious Disease I	National Rubella Surveillance in the Elimination Setting: Modernizing the Rubella Case Definition
151 G	Infectious Disease II	Responding to Highly Pathogenic Avian Influenza in Domestic Poultry and Wildlife in WA: Challenges and Opportunities from the Public Health Perspective
Regency Ballroom C/D	Position Statements (Members Only)	Infectious Disease
Solitude	Special Topics I	Improving Indoor Air Quality Laws & Policies
252 AB	Special Topics II	Principles for Using Public Health Data to Drive Equity: An Interactive, Practice-Based Session on Infusing Equity throughout the Data Lifecycle
Alta	Sponsor	Is your disease surveillance system ready to be modernized?, Presented by HLN



ROUNDTABLE SESSIONS

7:30am–8:15am

◆ Hyatt Regency Salt Lake City

◆ Salt Palace Convention Center

ROOM	COMMITTEE	SESSION
Snowbird	Substance Use & Mental Health/Injury	Standardizing Evaluation Efforts: The Development of the Overdose Prevention Performance Indicators Toolkit
151 DEF	Surveillance/ Informatics I	For You, By You, with You: Create the Open-Source Building Blocks of Public Health Response with CDC
Snowbasin	Surveillance/ Informatics II	National Syndromic Surveillance Program Community of Practice Networking Roundtable
Powder Mountain	Workforce Development	Multiple Hats, One Really Big Brain: Public Health Epidemiologists Serving as Informaticists Too

POSTER SESSIONS

8:15am–8:45am

Poster presentations during these sessions are displayed from Tuesday at 7:30AM until Wednesday at 12PM.



BREAKOUT SESSIONS

8:45am–10:00am

◆ Hyatt Regency Salt Lake City

◆ Salt Palace Convention Center

ROOM	COMMITTEE	SESSION
254 ABC	Chronic Disease/ Maternal and Child Health	Supporting Healthy Families through Surveillance for the Drivers of Fetal and Infant Mortality
255 E	Environmental Health/ Occupational Health I	Moving Mountains: Cross-Cutting Topics in Environmental and Occupational Health
255 F	Environmental Health/ Occupational Health II	Arching from Farming to Logging to Pesticides
150 DEFG	Infectious Disease I	Enteric Alphabet Soup: From Food Delivery to Goat Camp
251 ABC	Infectious Disease II	Making Fresh Tracks To Improve HIV/ STD Surveillance
251 DEF	Infectious Disease III	Elevating the New, Novel, and Unknown
255 C	Infectious Disease IV	Salt Lake COVID
Grand Ballroom I	Substance Use & Mental Health/Injury I	A Great Basin of Injury, Substance Use, and Mental Health Epi Topics
Grand Ballroom J	Substance Use & Mental Health/Injury II	Developing Effective Overdose Alerting Mechanisms
250 ABC	Surveillance/ Informatics I	How Data Linkage and Exchange Supports Collaboration



BREAKOUT SESSIONS

8:45am–10:00am

◆ Hyatt Regency Salt Lake City

◆ Salt Palace Convention Center

ROOM	COMMITTEE	SESSION
250 DEF	Surveillance/ Informatics II	The Fast and the Furious of Public Health: Exposure Notifications
255 A	Surveillance/ Informatics III	The Bonneville Salt Flats: Surveillance and Informatics in a Flash
255 B	Workforce Development	Train to Sustain: Building the Applied Epidemiology Workforce

POSTER SESSIONS

10:00am–10:30am

Poster presentations during these sessions are displayed from Tuesday at 7:30AM until Wednesday at 12PM.

PLENARY SESSIONS

**Environmental Justice / Advocacy:
One Planet for All of Us**

10:30am–11:45am ◆ Grand Ballroom A-H

Ben Abbott, PhD

Brigham Young University

Abdul El-Sayed, PhD, MD

*Wayne County Department of Health,
Human & Veterans Services*



Tuesday

JUNE 27 • 2023

JONATHAN M MANN MEMORIAL LECTURE

◆ Salt Palace Convention Center

12:00pm–12:30pm ◆ Grand Ballroom A-H

Dr. Alfred (Al) DeMaria, Jr., MD

JUNE 27 2023 / TUESDAY



ROUNDTABLE SESSIONS 12:45pm–1:30pm

◆ Hyatt Regency Salt Lake City

◆ Salt Palace Convention Center

ROOM	COMMITTEE	SESSION
Powder Mountain	Chronic Disease/ Maternal and Child Health	Chronic Disease and Maternal and Child Health Steering Committee: Highlighting Current Trends and Challenges in CD/MCH Epidemiology Capacity
Snowbasin	Environmental Health/ Occupational Health	Shared Positive Climate and Health Impacts of Evidence-Based Interventions for Public Health Problems – Development of a New Public Health Resource
151 ABC	Infectious Disease I	Antimicrobial Resistance Surveillance Task Force: Progress and Engagement
151 G	Infectious Disease II	Perinatal Hepatitis C: Considerations for the Initiation and Maintenance of Surveillance and Outreach Programs with Varying Resources
Regency Ballroom C/D	Position Statements <i>(Members Only)</i>	Infectious Disease
Solitude	Special Topics I	Improving Collection of Data for Notifiable Diseases Among Persons Experiencing Homelessness, Persons with Disabilities, and Persons with Substance Use Disorders
Aspen	Special Topics II	CSTE in Washington DC: Policy and Advocacy Priorities



ROUNDTABLE SESSIONS 12:45pm–1:30pm

◆ Hyatt Regency Salt Lake City

◆ Salt Palace Convention Center

ROOM	COMMITTEE	SESSION
Brighton	Sponsor I	Simplifying Public Health Practice: Customizable Solutions for Automating Epidemiology Tasks, <i>Presented by Ruvos</i>
Alta	Sponsor II	A New View for Flu: SAS' partnership with the Texas Department of State Health Services, <i>Presented by SAS</i>
Park City	Substance Use & Mental Health/ Injury	Implementing Injury Data Science Competencies: Planning for the Modernization of Injury Data Analytics
151 DEF	Surveillance/ Informatics I	Surveillance & Informatics Steering Committee Meeting - New Members Welcome
252 AB	Surveillance/ Informatics II	Project Emrge: Connecting Public Health and Emergency Medicine
Snowbird	Workforce Development	Infectious Disease Epidemiology Capacity Gaps at State and Local Health Departments and COVID-19 Case Reporting by State and Local Public Health Partners for the Purposes of Federal Public Health Travel Restrictions between January 2020 and April 2022



BREAKOUT SESSIONS

2:00pm–3:15pm

◆ Hyatt Regency Salt Lake City

◆ Salt Palace Convention Center

ROOM	COMMITTEE	SESSION
255 C	Chronic Disease/ Maternal and Child Health I	Prioritizing the Heartbeat of Pregnancy
255 B	Chronic Disease/ Maternal and Child Health II	Planning for the Best: Bringing Healthy Programs to the Community
255 E	Environmental Health/ Occupational Health I	Wastewater Surveillance
255 F	Environmental Health/ Occupational Health II	Methods and Miscellany
255 A	Environmental Health/ Occupational Health III	CSTE Occupational Health Subcommittee Meeting
150 DEFG	Infectious Disease I	Mutation at Warp Speed
251 ABC	Infectious Disease II	A pox o' your throat (W.Shakespeare)
251 DEF	Infectious Disease III	Scaling the Cliff of HAI Outbreaks
254 ABC	Infectious Disease IV	The Great Zoonotic Mix: Zoonotic Disease Trends and Case Reports



BREAKOUT SESSIONS

2:00pm–3:15pm

◆ Hyatt Regency Salt Lake City

◆ Salt Palace Convention Center

ROOM	COMMITTEE	SESSION
Grand Ballroom I	Substance Use & Mental Health/ Injury I	Using Morbidity Records to Inform Overdose Surveillance
Grand Ballroom J	Substance Use & Mental Health/ Injury II	The Sundance to Health Equity: Topics in Injury, Substance Use and Mental Health
250 ABC	Surveillance/ Informatics I	Don't Be a Data Dinosaur: Modernizing Public Health Data Infrastructure
250 DEF	Surveillance/ Informatics II	Data Quality Rocks: Enhancing Data Quality for Better Public Health Outcomes

POSTER SESSIONS

3:15pm–3:45pm

Poster presentations during this session are displayed from Tuesday at 7:30AM until Wednesday at 12PM.



BREAKOUT SESSIONS

3:45pm–5:00pm

◆ Hyatt Regency Salt Lake City

◆ Salt Palace Convention Center

ROOM	COMMITTEE	SESSION
255 B	Chronic Disease/ Maternal and Child Health I	Cost, Trend, and Impact of Chronic Diseases
255 C	Chronic Disease/ Maternal and Child Health II	Neonatal Abstinence Syndrome (NAS) Surveillance
255 E	Environmental Health/ Occupational Health I	Over the Mountain and Headed to the Valley: Let's Talk COVID-19
255 F	Environmental Health/ Occupational Health II	Environmental Health: Lead
150 DEFG	Infectious Disease I	Making Connections: Updates on COVID and Influenza
251 ABC	Infectious Disease II	Striving for the Summit of AR Surveillance
Regency Ballroom C/D	Position Statement Voting Session (<i>Members Only</i>)	Infectious Disease II of III
254 ABC	Special Topics I	Discussing Disparities
251 DEF	Special Topics II	Preparedness and Response: Novel Pilots, Testing and Assessments



BREAKOUT SESSIONS

3:45pm–5:00pm

◆ Hyatt Regency Salt Lake City

◆ Salt Palace Convention Center

ROOM	COMMITTEE	SESSION
Grand Ballroom I	Substance Use & Mental Health/ Injury I	Overdose and all that (Utah) Jazz: Topics on Drug Overdose and Health Equity
Grand Ballroom J	Substance Use & Mental Health/ Injury II	Enough to Fill the Great Salt Lake: Alcohol Access, Consumption, and Health Outcomes
250 ABC	Surveillance/ Informatics I	Diving into the Great Salt Lake: Novel Approaches to Informatics Challenges
250 DEF	Surveillance/ Informatics II	Jazz Up Your Case Notifications: Staying Ahead of the Curve



ROUNDTABLE SESSIONS

5:15pm–6:00pm

◆ Hyatt Regency Salt Lake City

◆ Salt Palace Convention Center

ROOM	COMMITTEE	SESSION
Snowbird	Environmental Health/ Occupational Health	Occupational Health Indicators Workgroup Meeting
151 ABC	Infectious Disease I	Council for Outbreak Response: Healthcare-Associated Infections and Antimicrobial Resistant Pathogens (CORHA) – Experiences Implementing a Notifications Framework in the Context of Healthcare Outbreaks
151 G	Infectious Disease II	Improving the Integrated Foodborne, Waterborne, Enteric, and Environmentally Transmitted Diseases Cooperative Agreement Program
Powder Mountain	Infectious Disease III	Sars-Cov-2 Surveillance and Capacity Building at the Human-Animal-Environment Interface
Park City	Special Topics	Utilizing Applied Epidemiology and Community Partnerships to Promote Equitable Emergency Preparedness and Resiliency Building That Improve the Lives of Vulnerable Residents and Staff in Long Term Care Facilities



ROUNDTABLE SESSIONS

5:15pm–6:00pm

◆ Hyatt Regency Salt Lake City

◆ Salt Palace Convention Center

ROOM	COMMITTEE	SESSION
Brighton	Sponsor	Aligning Health Atlases Toward Equity: An intersectoral approach to hyperlocal data in Chicago and Cook County, <i>Presented by Metopio</i>
Solitude	Substance Use & Mental Health/Injury	Challenges in Race Classification and Disaggregation: A Case Study of Native Hawaiian/Pacific Islander Minnesotans and Drug Overdose and Substance Use
151 DEF	Surveillance/ Informatics I	Federal Datasets for Public Health and Healthcare Interoperability – Uscdi and Uscdi+
252 AB	Surveillance/ Informatics II	Status and Development Horizon of Analytic Tools in Syndromic Surveillance
Snowbasin	Workforce Development	Establishing Data Sharing, Data Engagement, and Data Accessibility Standards with Community Partners to Support Community Needs and Inform Public-Facing Visualizations

A decorative background with a light green geometric pattern. A large, stylized house shape is outlined in a thick green border. The word "notes" is written in a dark blue, serif font in the top left corner. The interior of the house shape is white and contains horizontal lines for writing.

Wednesday

DAY 3

JUNE
28



Salt Lake City
UTAH



Epidemiology Elevated: Supporting People and Places

#CSTE2023

#CSTE2023

**Epidemiology Elevated:
Supporting People and Places**





DAILY GLANCE

◆ Hyatt Regency Salt Lake City		◆ Salt Palace Convention Center	
START	END	ROOM	FUNCTION
8:00am	11:00am	Salt Lake Ballroom Foyer	Check-In and On-Site Registration
8:00am	2:00pm	Wasatch	Position Statement Office
8:00am	12:00pm	150 AB	Speaker Ready Room
8:00am	12:00pm	255 D	Quiet Working Room
8:00am	11:00am	Salt Lake Ballroom	Networking Hall
8:15am	8:45am	Salt Lake Ballroom	Break ☕
10:00am	10:30am	Salt Lake Ballroom	Break ☕
11:45am	12:45pm	Salt Lake Ballroom Foyer	Break and Lunch on Own
1:30pm	2:00pm	Salt Lake Ballroom Foyer	Break and Lunch on Own
3:15pm	4:00pm	Salt Lake Ballroom Foyer	Break ☕

Lactation rooms are available at the Salt Palace Convention Center off of the Lower Concourse between the North Ballroom Foyer and Room 150 A (underneath the triple escalators) and across from Room 254 between the bathrooms.

POSTER SESSIONS

8:15am–8:45am

10:00am–10:30am

Poster presentations during these sessions are displayed from Tuesday at 7:30AM until Wednesday at 12PM.



ROUNDTABLE SESSIONS

7:30am–8:15am

◆ Hyatt Regency Salt Lake City

◆ Salt Palace Convention Center

ROOM	COMMITTEE	SESSION
Snowbird	Environmental Health/ Occupational Health	Beyond the Tractor: Strategies for Developing a Comprehensive Farmworker Injury Surveillance System
151 ABC	Infectious Disease I	Standardizing COVID-19-Associated Mortality Surveillance: Successes, Challenges, and Lessons Learned
151 G	Infectious Disease II	Identifying Intervention Opportunities Using the National Healthcare Safety Network Targeted Assessment for Antimicrobial Stewardship Group Function
Regency Ballroom C/D	Position Statements (Members Only)	Infectious Disease
Solitude	Special Topics	Leveraging Data to Advance Health Equity: Considerations for Implementing Health Equity Science in State and Local Health Departments
Brighton	Sponsor I	The importance of next-generation record matching to accurately identify, engage and manage the whole person across your entire ecosystem, <i>Presented by Verato</i>
Alta	Sponsor II	Demystifying Data Governance to Meet Needs Across a Public Health Agency, <i>Presented by Guidehouse</i>



Wednesday

JUNE 28 • 2023

ROUNDTABLE SESSIONS

7:30am–8:15am

◆ Hyatt Regency Salt Lake City

◆ Salt Palace Convention Center

ROOM	COMMITTEE	SESSION
Powder Mountain	Substance Use & Mental Health/Injury	Rxcheck: Identifying Barriers to EHR Integration and Discussion Towards Solutions
151 DEF	Surveillance/ Informatics I	Data for Action: A Framework for the Future of Public Health
Snowbasin	Surveillance/ Informatics II	Bluetooth Exposure Notification and Its Possible Usefulness for Public Health Situations Beyond COVID-19
Park City	Workforce Development	Developing the Modeling Public Health Workforce through Training, Capacity Building, and Knowledge Sharing to Respond to Infectious Disease Threats

POSTER SESSIONS

8:15am–8:45am

Poster presentations during this session are displayed from Tuesday at 7:30AM until Wednesday at 12PM.

JUNE 28 2023 / WEDNESDAY



BREAKOUT SESSIONS

8:45am–10:00am

◆ Hyatt Regency Salt Lake City

◆ Salt Palace Convention Center

ROOM	COMMITTEE	SESSION
255 B	Chronic Disease/ Maternal and Child Health	Elevating MCH Surveillance to Improve Outcomes
255 E	Environmental Health/ Occupational Health I	Wastewater Surveillance II
255 F	Environmental Health/ Occupational Health II	A Rock-Solid Adventure in Worker's Comp Claims and Novel Methods
251 ABC	Infectious Disease I	Expanding the HIV(e) – What's New With HIV/STD Surveillance
251 DEF	Infectious Disease II	Reaching New Heights in HAI Prevention and Response
255 A	Infectious Disease III	Lions, Mosquitoes, and Pets - Oh My!: Zoonotic Disease Surveillance and Response
255 C	Infectious Disease IV	Redux and Influx
150 DEFG	Special Topics I	Late Breaker
254 ABC	Special Topics II	Travel Restrictions to Contact Tracing for Outbreak Control
Grand Ballroom I	Substance Use & Mental Health/Injury I	Place Matters: Traversing the Mountains of Mental Health Epidemiology



Wednesday

JUNE 28 • 2023

BREAKOUT SESSIONS

8:45am–10:00am

♦ Hyatt Regency Salt Lake City

♦ Salt Palace Convention Center

ROOM	COMMITTEE	SESSION
Grand Ballroom J	Substance Use & Mental Health/Injury II	Substance Use and Drug Overdose Prevention Through Harm Reduction Approaches
250 ABC	Surveillance/ Informatics I	Automation Nation: Leveraging Technology to Streamline Public Health Processes
250 DEF	Surveillance/ Informatics II	Winning the Marathon: Improving Electronic Case Reporting

POSTER SESSIONS

10:00am–10:30am

Poster presentations during these sessions are displayed from Tuesday at 7:30AM until Wednesday at 12PM.

PLENARY SESSIONS

Public Health Communications: Putting the Community in our Communications

10:30am–11:45am ♦ Grand Ballroom A-H

Katelyn Jetelina, MPH, PhD
Population Health Analytics

Lena H. Sun, MA
National Reporter Focusing on Health, Washington Post

JUNE 28 2023 / WEDNESDAY



ROUNDTABLE SESSIONS 12:45pm–1:30pm

◆ Hyatt Regency Salt Lake City

◆ Salt Palace Convention Center

ROOM	COMMITTEE	SESSION
Snowbasin	Chronic Disease/ Maternal and Child Health	CSTE NAS Surveillance Implementation
Snowbird	Environmental Health/ Occupational Health	CSTE Disaster Epidemiology Subcommittee: Integrating Epidemiology into Response and Communicating to Leadership on the Role of Epidemiology
151 ABC	Infectious Disease	Into the Great Unknown: Onsite Hemodialysis in Long-Term Care Facilities
Regency Ballroom C/D	Position Statements (Members Only)	Infectious Disease
Park City	Special Topics	Lessons Learned in Gaining Access to United States Mpox Vaccine Administration Data for Public Health Action at the National Level
Brighton	Sponsor	Public Health: The Art of the Now, Presented by Amazon Web Services
Solitude	Substance Use & Mental Health/Injury	Application of EMS Data for Firearm Injury Surveillance



Wednesday

JUNE 28 • 2023

ROUNDTABLE SESSIONS 12:45pm–1:30pm

◆ Hyatt Regency Salt Lake City

◆ Salt Palace Convention Center

ROOM	COMMITTEE	SESSION
151 G	Surveillance/ Informatics I	Electronic Case Reporting (eCR) and Reportable Conditions Knowledge Management System (RCKMS) Community of Practice Annual Roundtable
151 DEF	Surveillance/ Informatics II	Injury and General Data Science Capacity Assessment with Results from Colorado and Oregon
Alta	Surveillance/ Informatics III	Moving Towards Standardized Data Elements for Case Surveillance
Powder Mountain	Workforce Development	A More Perfect Union: Building and Maintaining Relationships Among Federal, State, and Local Public Health Partners and Develop Public, Private and Academic Partnership to Fill Gaps in Skills to Strengthen Public Health Workforce Response Readiness: Texas Sars-Cov-2 Variant Surveillance Networking Project as a Model

JUNE 28 2023 / WEDNESDAY

Wednesday

JUNE 28 • 2023



BREAKOUT SESSIONS

2:00pm–3:15pm

◆ Hyatt Regency Salt Lake City

◆ Salt Palace Convention Center

ROOM	COMMITTEE	SESSION
Grand Ballroom I	Infectious Disease I	Soaring to New Heights: Updates on Respiratory Diseases
Grand Ballroom J	Infectious Disease II	Elevating Enteric: Data and Investigations
150 DEFG	Infectious Disease III	Carving A New Path To Hepatitis C Testing And Treatment In Substance Use Disorder & Correctional Facilities
Regency Ballroom C/D	Position Statement Voting Session (Members Only)	Chronic Disease/Maternal and Child Health

BREAKOUT SESSIONS

4:00pm–6:30pm

ROOM	COMMITTEE	SESSION
Regency Ballroom C/D	Position Statement Voting Session (Members Only)	Infectious Disease III of III

Thursday

**CSTE
Business
Meeting**

**JUNE
29**



Salt Lake City
UTAH



Epidemiology Elevated: Supporting People and Places

#CSTE2023

#CSTE2023

**Epidemiology Elevated:
Supporting People and Places**





CSTE BUSINESS MEETING

(Members-Only)

◆ Hyatt Regency Salt Lake City

8:30am–12:00pm ◆ Regency Ballroom C/D

The conference concludes with the Business Meeting for the CSTE membership to discuss the business of CSTE and review position statements. All current members are welcome to attend the meeting. Official CSTE decisions are made by vote with only one vote per state or territory cast by the State Epidemiologist or an official Active member representative from the state or territory designated by the State Epidemiologist.



notes

Sponsors and Exhibitors



Salt Lake City
UTAH



Epidemiology Elevated: Supporting People and Places

#CSTE2023

#CSTE2023

**Epidemiology Elevated:
Supporting People and Places**





Sponsors

CSTE sincerely thanks our sponsors and exhibitors for supporting the conference. CSTE is committed to public-private partnerships that improve public health. Please take time during the conference to visit with our sponsors and exhibitors in the Networking Hall or attend a sponsored roundtable session.

GOLD LEVEL SPONSORS



GOLD LEVEL SPONSORS

Sponsors



SILVER LEVEL SPONSORS





Exhibitors

Altarum

Chexout Inc.

Clinisys

CTEH

Datapult, an APHL Company

Deloitte Consulting LLP

Electronic Case Reporting (eCR)

End Point Corporation

Healthy Together

J Michael Consulting

National Board of Public Health Examiners (NBPHE)

People.Health

Public Health Informatics Institute

Ratio PBC

Resultant

Wehealth

Hyatt Regency Salt Lake City LEVEL 2 / SALT LAKE BALLROOM

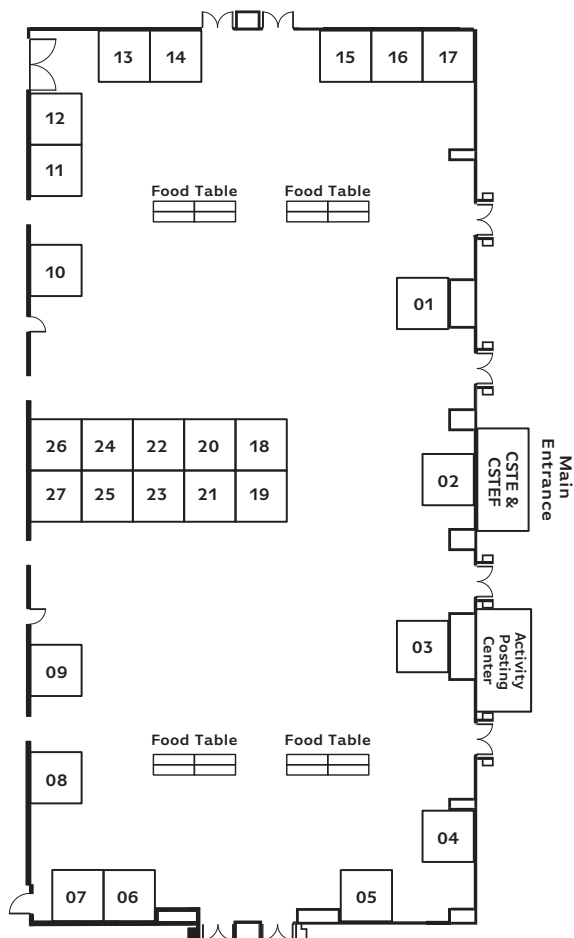



Hyatt Regency Salt Lake City

LEVEL 2 / SALT LAKE BALLROOM

COMPANY	BOOTH
Altarum	5
Amazon Web Services	9
Chexout Inc.	22
The Chronic Disease GIS Network (CDGISN)	1
Clinisys	12
Conduent Government Healthcare Solutions	2
CSTE & CSTE Foundation	Foyer
CTEH	23
Datapult, an APHL Company	16
Deloitte Consulting LLP	6
Electronic Case Reporting (eCR)	26
End Point Corporation	15
Guidehouse	8
Healthy Together	25
HLN	20
InductiveHealth Informatics	3
J Michael Consulting	11
LexisNexis Risk Solutions	21
Metopio	n/a
National Board of Public Health Examiners (NBPHE)	24
People.Health	17
Public Health Informatics Institute	13
Ratio PBC	27
Resultant	7
Roche	10
Ruvos	18
SAS	19
Verato	4
Wehealth	14

Sponsor

ROUNDTABLE SESSIONS

Gold Sponsor

ROUNDTABLE SESSIONS

The Chronic Disease GIS Network (CDGISN) | Gold Sponsor

Monday, June 26, 2023
5:15pm – 6:00pm

Hyatt Regency
Salt Lake City ♦ Brighton

The Chronic Disease GIS Network (CDGISN): Enhancing GIS Capacity for Chronic Disease Prevention

Conduent Government Healthcare Solutions | Gold Sponsor

Monday, June 26, 2023
12:45pm – 1:30pm

Hyatt Regency
Salt Lake City ♦ Brighton

Public Health Department Easily Configures Custom Childhood Lead Surveillance Software to Meet Unique Needs



Sponsor

ROUNDTABLE SESSIONS

InductiveHealth Informatics | Gold Sponsor

Monday, June 26, 2023
12:45pm – 1:30pm

Hyatt Regency
Salt Lake City ♦ Alta

Pulling It All Together: Integrating Public Health Informatics Solutions to Improve Efficiencies and Implement Lessons Learned

Ruvos | Gold Sponsor

Tuesday, June 27, 2023
12:45pm – 1:30pm

Hyatt Regency
Salt Lake City ♦ Brighton

Simplifying Public Health Practice: Customizable Solutions for Automating Epidemiology Tasks

SAS | Gold Sponsor

Tuesday, June 27, 2023
12:45pm – 1:30pm

Hyatt Regency
Salt Lake City ♦ Alta

A New View for Flu: SAS' partnership with the Texas Department of State Health Services

Sponsor

ROUNDTABLE SESSIONS

Silver Sponsor

ROUNDTABLE SESSIONS

Amazon Web Service | Silver Sponsor

Wednesday, June 28, 2023
12:45pm – 1:30pm

Hyatt Regency
Salt Lake City ♦ Brighton

Public Health: The Art of the Now

Guidehouse | Silver Sponsor

Wednesday, June 28, 2023
7:30am – 8:15am

Hyatt Regency
Salt Lake City ♦ Alta

Demystifying Data Governance
to Meet Needs Across a Public
Health Agency

HLN | Silver Sponsor

Tuesday, June 27, 2023
7:30am – 8:15am

Hyatt Regency
Salt Lake City ♦ Alta

Is your disease surveillance
system ready to be modernized?



Sponsor

ROUNDTABLE SESSIONS

LexisNexis Risk Solutions | Silver Sponsor

Monday, June 26, 2023
7:30am – 8:15am

Hyatt Regency
Salt Lake City ♦ Brighton

Public Health | How Referential Data Catalyzes Patient Matching and Public Health Research

Metopio | Silver Sponsor

Tuesday, June 27, 2023
5:15pm – 6:00pm

Hyatt Regency
Salt Lake City ♦ Alta

Aligning Health Atlases Toward Equity: An intersectoral approach to hyperlocal data in Chicago and Cook County

Verato | Silver Sponsor

Wednesday, June 28, 2023
7:30am – 8:15am

Hyatt Regency
Salt Lake City ♦ Brighton

The importance of next-generation record matching to accurately identify, engage and manage the whole person across your entire ecosystem



notes

CSTE Connect is a new online community for CSTE members and stakeholders to discuss and share resources with each other. This exciting new benefit offers members the opportunity to interact in one or more specialized online communities with colleagues and peers.

Visit the CSTE booth to learn more.



Supporting Applied Epidemiologists



Learn more, and donate today, at
www.cstefoundation.org



notes

The image is a full-page decorative background. It features a light green, geometric, low-poly pattern. Overlaid on this is a large, stylized house shape defined by a thick green border. The word "notes" is positioned in the top left corner in a dark blue, serif font. The interior of the house shape is white and contains horizontal lines for writing. The lines are thin and light gray, with a slight gap at the top left where the word "notes" is located.



2024 ANNUAL CONFERENCE

**SAVE
THE DATE**

JUNE 9 – 13, 2024
Pittsburgh, Pennsylvania

csteconference.org

Call for Abstracts Opening Fall 2023



csteconference.org